

# CONCEALED HINGE

## W/ 3D ADJUSTMENT

### FEATURES:

- Can be used on interior or exterior doors.
- These hinges allow three-dimensional adjustment (depth, vertical and horizontal). This means the door can be aligned with the wall to perfection where there is frameless architectural.
- Recommended maximum opening angle of 120 degrees.
- Hinge reversible for right/left doors.
- Comes with Self-lubricating anti-friction washers.

### COMPONENTS:

- 1x 5972 3D Hinge
- 8x Fixing Screws
- 4x Covers
- 1x Allen Key

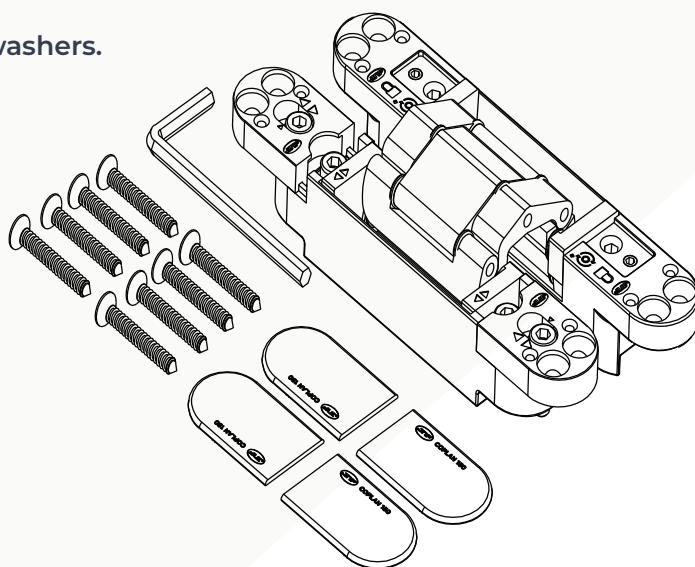

### WARNINGS

- Not recommended to use door closers with restraint system.
- The adjustments in 3 axes must be carried out on one axis at a time.
- Make small adjustments to the adjusting screws alternating hinge on hinge

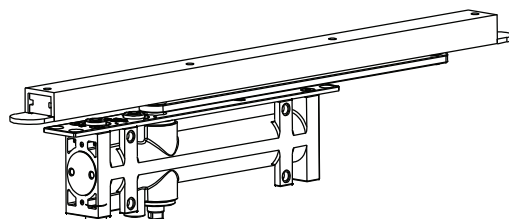

# CONCEALED HINGE W/ 3D ADJUSTMENT

## MEASUREMENTS

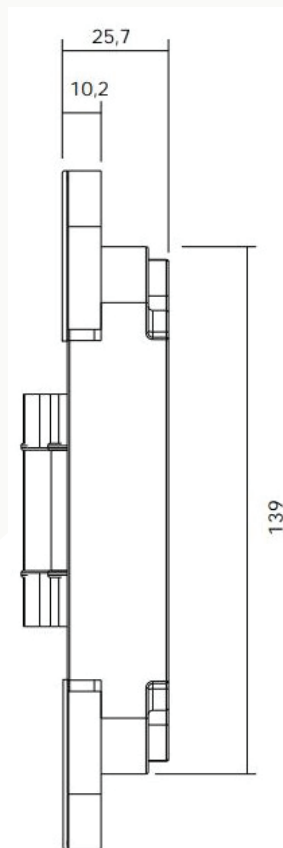
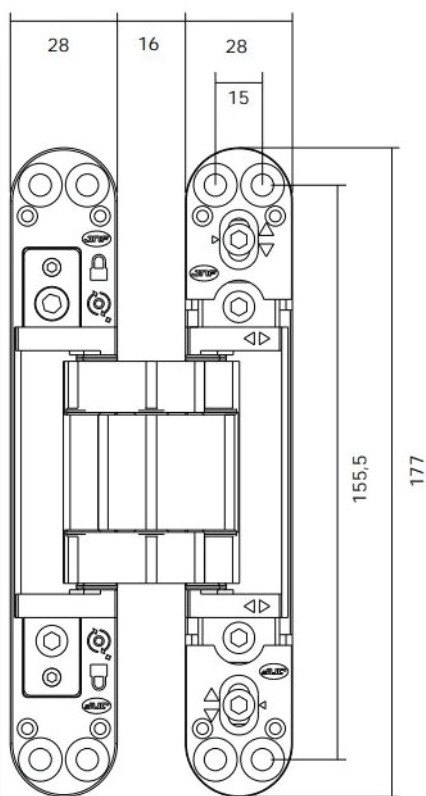
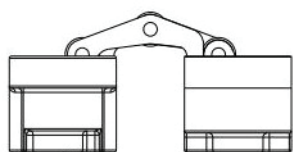
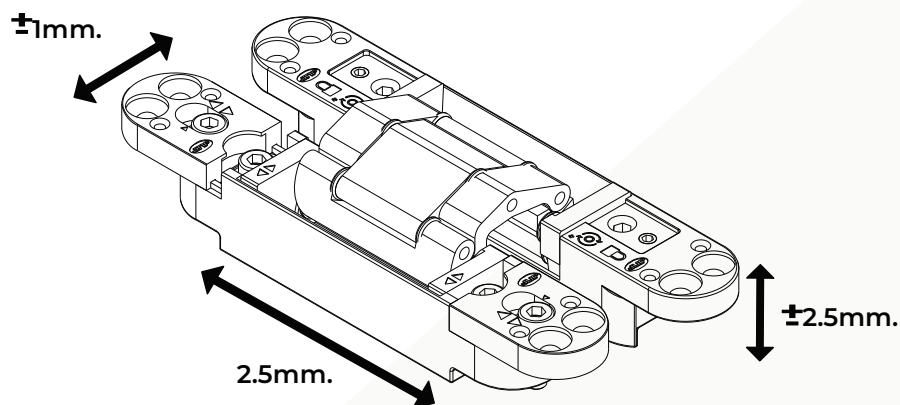

## CONCEALED HINGE W/ 3D ADJUSTMENT

### DOOR SPECIFICATIONS

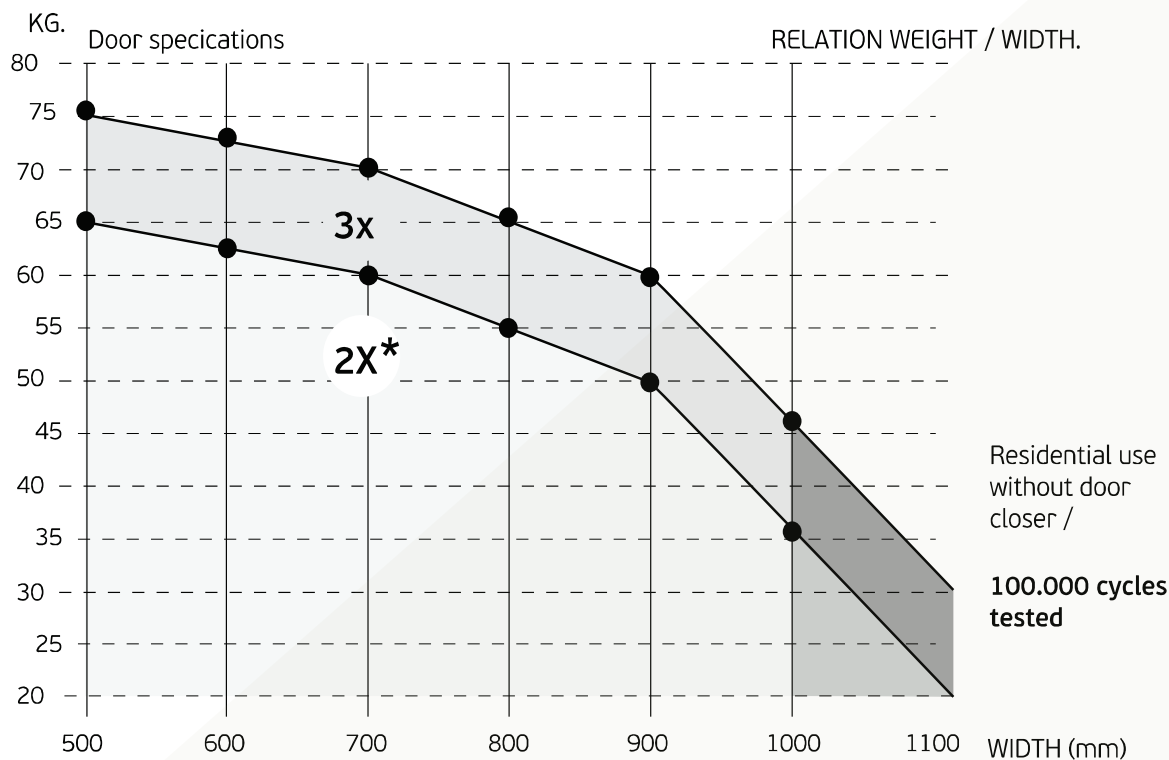

### Distribution

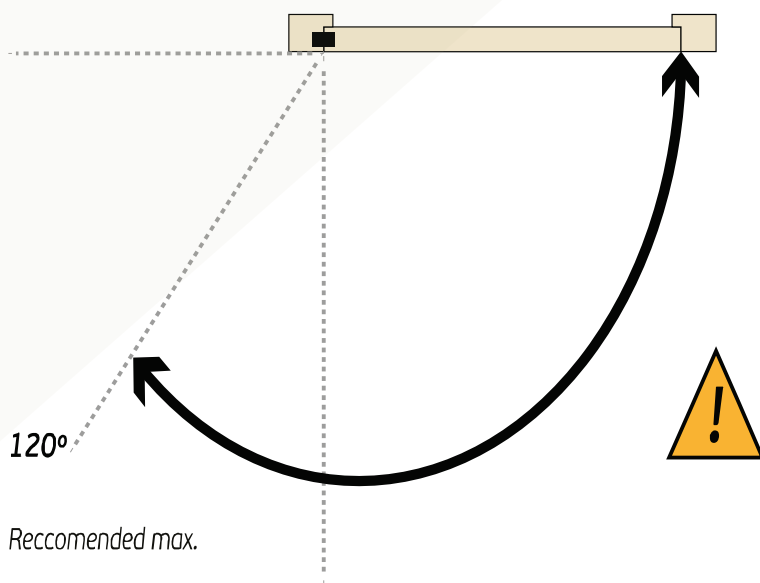
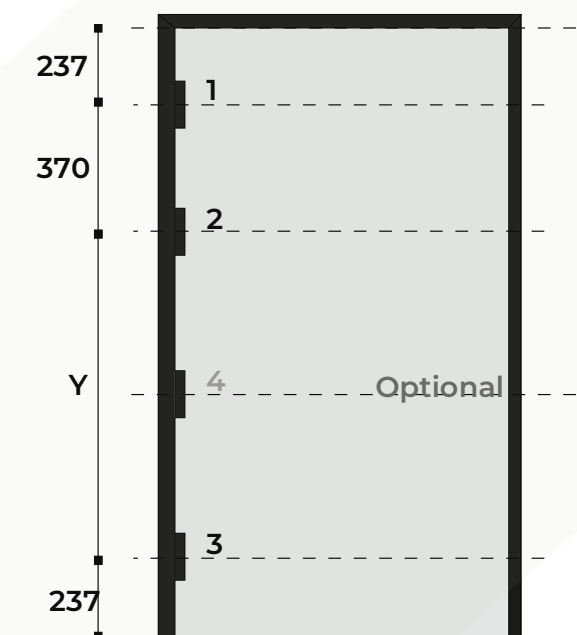

## CONCEALED HINGE W/ 3D ADJUSTMENT

### ADJUSTMENT

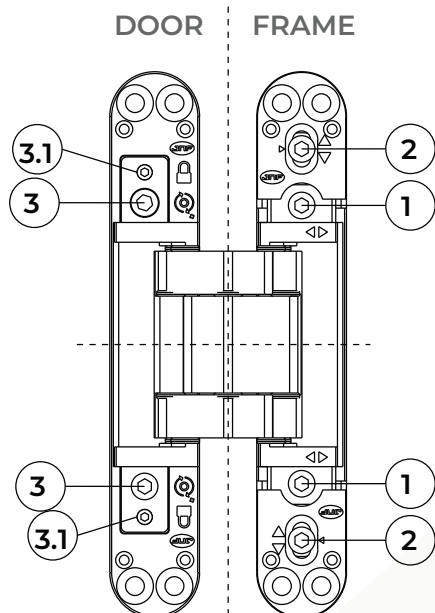

- ① • Depth adjustment. Loose the 2 screws of each hinge.
  - Adjust the position of the door.
  - Tighten all screws, torque 3 N/m. /
- ② • Vertical adjustment. Loose the 2 screws of each hinge.
  - Place a shim in the lower part of the door with the desired gap.
  - Tighten all screws, torque 3 N/m. /
- ③ • Horizontal adjustment. Loose the screws (3.1) of each hinge. Turning alternately the screws (3) in order to achieve the desired gap. To lock adjustment tighten all the Screws (3.1) Torque 3 N/m. /

### CUT OUT

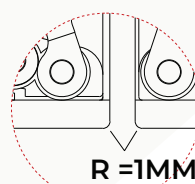
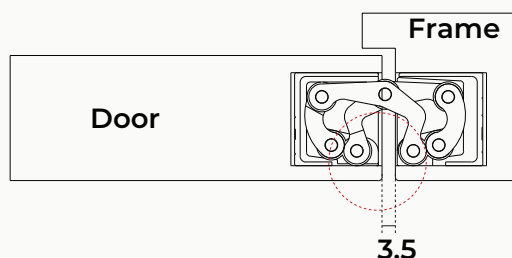
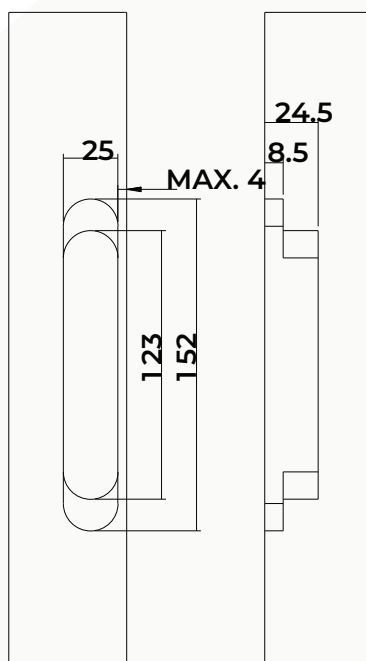

**WARNING R = 1MM ( MIN.)**

